

NEW LAUNCH CONDO

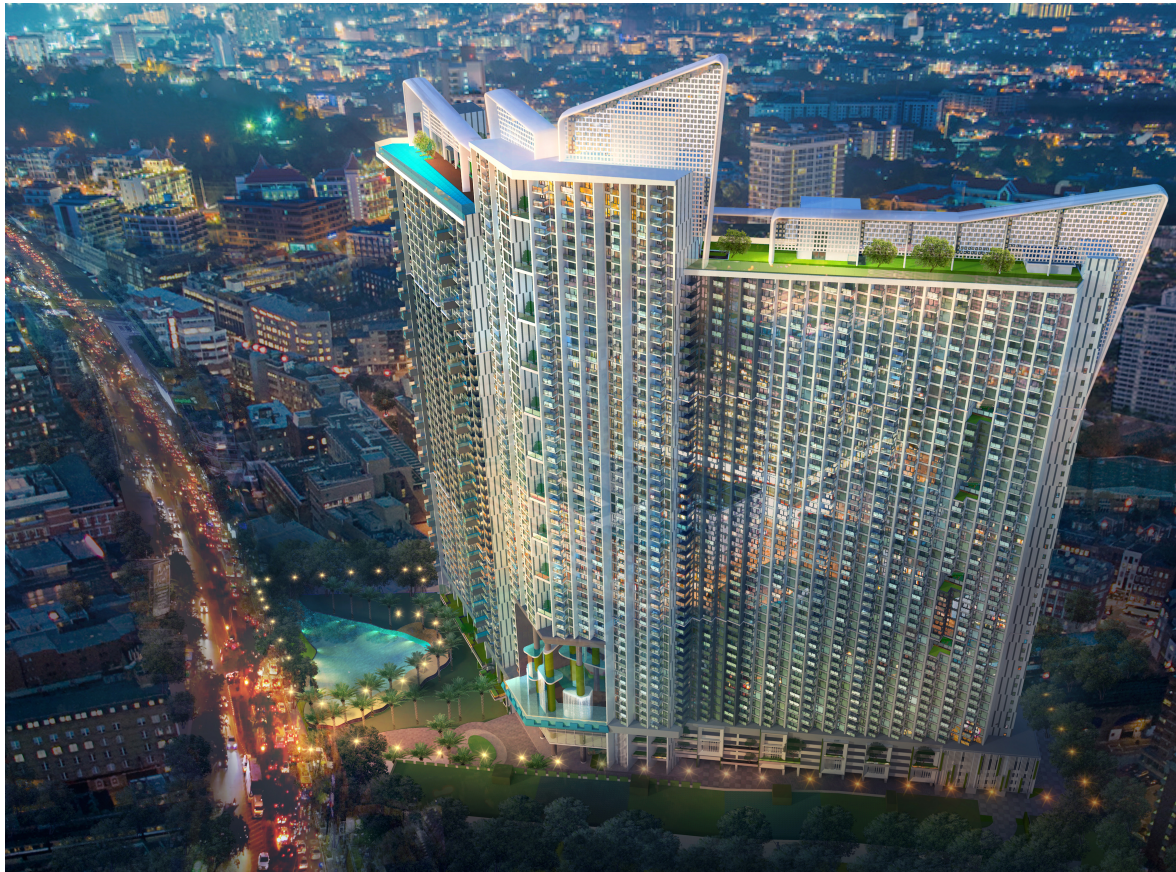

PROJECT DETAIL

Project Name	COPACABANA CORAL REEF
Developer	COPACABANA GROUP
Location	JOMTIEN SECOND ROAD OPPOSITE SOI 8
Property Type	HIGH RISE RESIDENTIAL DEVELOPMENT
Land Size	13 RAI 83 TARANG WAH
Tenure	FREE HOLD
Total Unit	1972 UNITS
Unit Mix	1 BR, 2 BR, 1 BR WITH PRIVATE POOL
Expect Completion Date	2028-29

COPACABANA CORAL REEF

The new launch condo in Jomtien, Pattaya, Copacabana Coral Reef will comprise of 1872 units, 56 storey high, sitting on 13 rai 73 tarang wah land. This is the modern luxurious residential condo conveniently located just 5 minutes walk to Jomtien beach, 2 minutes walk to Rompoh market, bars and restaurant. All unit types available from 1 bedroom, 2 bedroom, and 1 bedroom with private pool with half of units facing sea view, and the other half facing pool view and Pattaya city view. Including various modern amenities that uplift spirits and genuine elevated lifestyle.

AMENITIES

- 3 high ceiling lobbies with 11 elevators
- 24 garden common area on the building open to residents
- Large 3 rd floor gym with panoramic windows, cardio, weigh, and gymnastic area.
- 3 rd floor sauna and stem room
- 6 th floor ultimate waterfall, cantilever pool and kid pool
- 51 th floor rooftop infinity cantilever pool with jacuzzi
- Clubroom and meeting room
- Spacious garden with water fall and swimming pool on ground floor
- The carnival wave pool on ground floor
- Walking trail or bicycle trail on carpark building rooftop
- 5 storey carpark in the building and 2 storey carpark building
- Free WiFi in common areas
- 24 hr security

SINKING FUND : 500 Baht/sqm (One Time Payment)

MAINTENANCE FEE : 50 Baht/sqm (Payable 12 Months in Advance)

***Remark: This is preliminary specifications is subject to change without notice.**





COPACABANA CORAL REEF: More details

Land owner and project developer is Copacabana Coral Reef Co., Ltd., having registered address at 385/16 Moo 12, Tumbol Nongprue, Amphur Bang Lamung, Chonburi Province 20150, represented by Mrs. Kasina Thammasuwan, managing director, with registered capital of 4,000,000 Baht (fully paid 4,000,000 Baht).

The condominium project of Copacabana Coral Reef will be constructed on the land with Land Title Deed No. 11835, 336913, 185821, 25266, 220580, 6877, 1608, 170728 and 220579 Land Parcel No. 26, 25, 568, 20, 582, 19, 45, 548 and 581 Tumbol Nongprue, Amphur Bang Lamung, Chonburi Province. The project was EIA approved and the pilling has been ongoing currently.

The project is estimated to commence the construction on 2025 and should be completed on 2028-29.

